

FELIXOR

FELIXER 3.1 TRANSPORTATION AND DEPLOYMENT CRATE

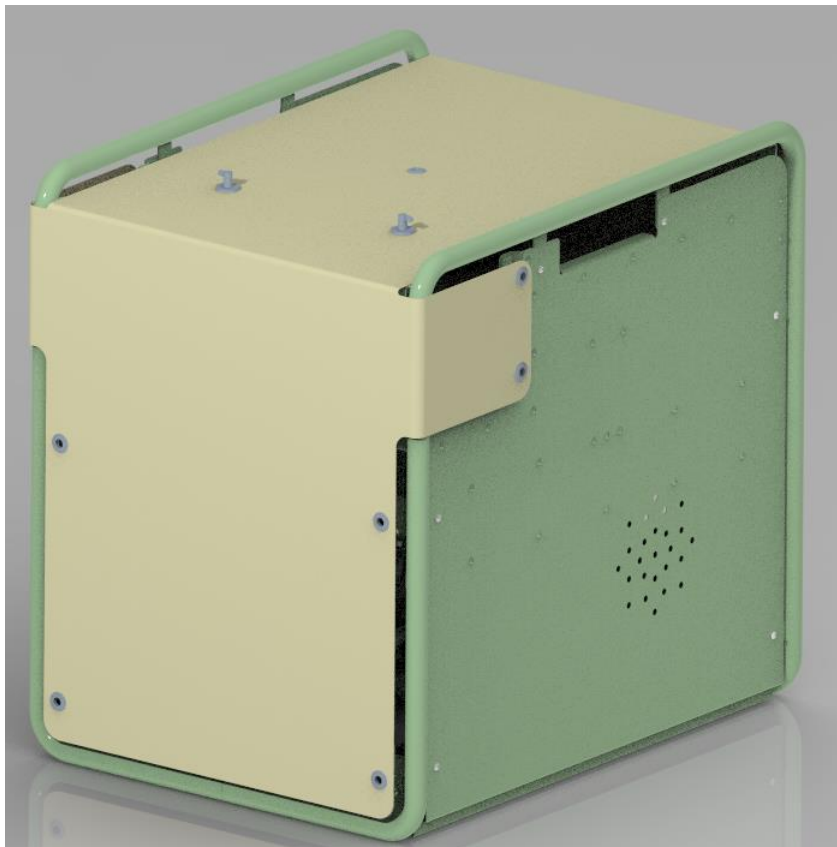

USER GUIDE

Contents

1	Introduction	3
1.1	Primary functions	3
1.2	Overview	3
2	Opening and accessing the crate	4
2.1.1	Release both ladder locks at the rear of the crate	4
2.1.2	Release the t-toggles at the 8 positions	4
2.1.3	The canvas should now be free and can be folded back	5
2.1.4	The back panel can slide up and out.	5
3	Deploying the Felixer in the crate	6
3.1	Removing the solar panel	6
3.1.1	Release the cam buckle strap	6
3.2	Releasing the Felixer	7
3.2.1	Release the Ratchet buckle	7
3.3	Deploying the Felixer	8
3.3.1	Access the accessories pouch	8
3.3.2	Follow the Felixer user manual on setting up the Felixer	8
3.4	Plugging/unplugging the charger/solar panel	9
	9
3.5	Closing the crate for deployment	9
3.5.1	Re-attaching the Felixers' retention buckle (ratchet buckle)	9
3.5.2	Attaching the canvas	10
3.5.3	Locking away the canvas for deployment	11
3.6	Alternate deployment of the Crate	12
	12
4	Deploying Felixer without crate	13
4.1	Removing the solar panel	13
4.1.1	Release the cam buckle strap	13
4.2	Releasing the Felixer	14
4.2.1	Release the Ratchet buckle	14
4.3	Lifting the Felixer	15
4.3.1	Safe lift procedure	15
4.4	Deploying the Felixer	15
4.4.1	Access the accessories pouch	15
4.4.2	Follow the Felixer user manual on setting up the Felixer	15
	15
5	Packaging Felixer for freight	16
5.1	Placing the Felixer	16

5.2	Tightening the Felixer retention strap	16
5.3	Add the solar panel	17
5.4	Tighten down the solar panel	17
5.5	Add back panel	17
5.6	Close canvas.....	18
5.7	Tighten canvas.....	19
5.8	add delivery label to rear.	19
5.9	Set for delivery	20

1 Introduction

1.1 Primary functions

The primary functions of the crate are as follows:

- Protection of the Felixer during transportation
 - o This involves the use of rubber pads for vibration dampening, and straps to retain the Felixer
- Optionally the crate can be used to house the Felixer in deployment for additional environmental protection, including from fire.

1.2 Overview

The crate consists of a steel tube bent frame, with aluminium panels. There is also a PVC cover that allows access to the Felixer which is held in place with T-toggles

1.2.1 Crate safe lift procedure

The crate is very heavy when loaded with a solar panel and the Felixer, the following 2-person lift procedure must be followed.

1. Two people required
2. Grasp the tubes at the handle openings.
3. Lift using your legs.
4. Maintain a straight back and arm whilst carrying the crate over long distance.

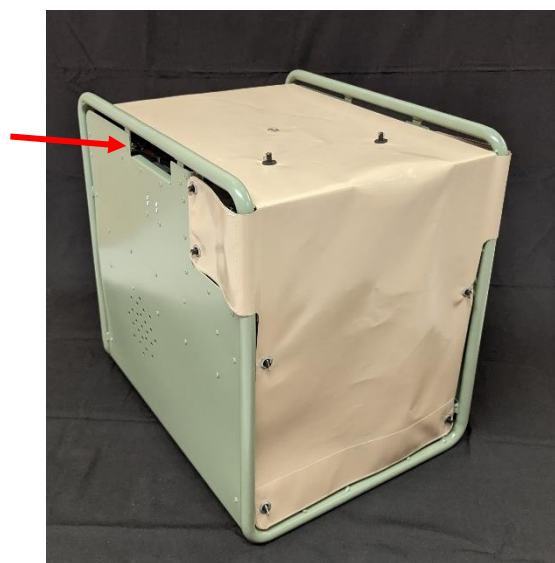

2 Opening and accessing the crate

2.1.1 Release both ladder locks at the rear of the crate
This will release tension from the canvas



2.1.2 Release the t-toggles at the 8 positions.



2.1.3 The canvas should now be free and can be folded back
The rear straps can come clear from the retaining hooks (circled in red)



2.1.4 The back panel can slide up and out.



3 Deploying the Felixer in the crate

3.1 Removing the solar panel

3.1.1 Release the cam buckle strap

Refer <https://youtu.be/uWPqj-Yc-2c> for how to operate a cam buckle.

With the solar panel free, it can be pulled directly up and out of the crate.

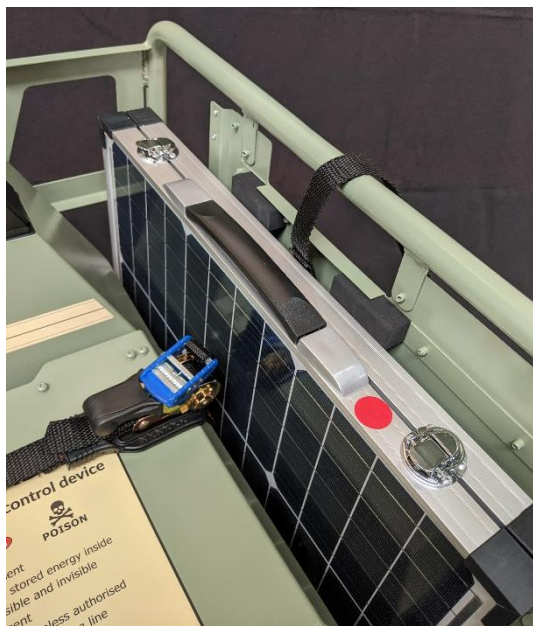

3.2 Releasing the Felixer

3.2.1 Release the Ratchet buckle

The Felixer can now be accessed by releasing the ratchet straps.

Refer to <https://youtu.be/uZIkIOHOkNo> for how operate a ratchet straps buckle.

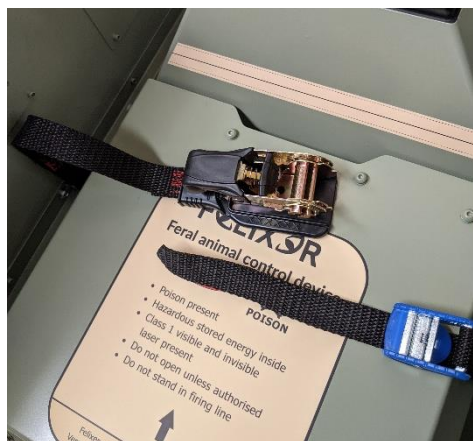
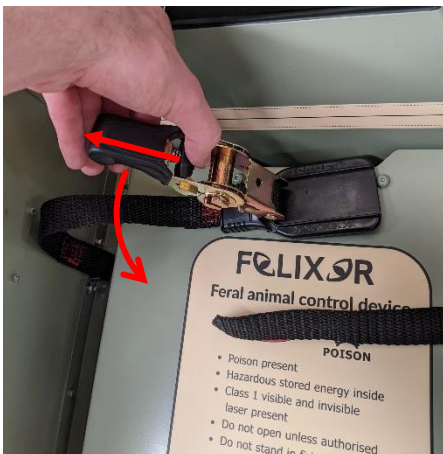
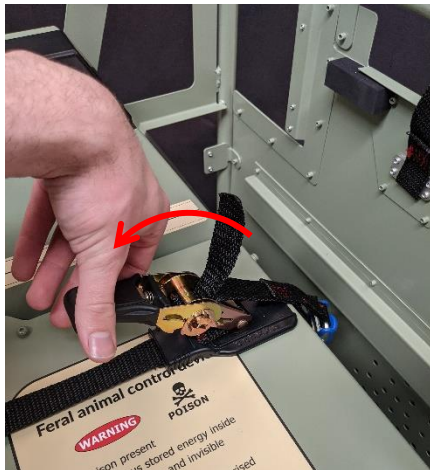
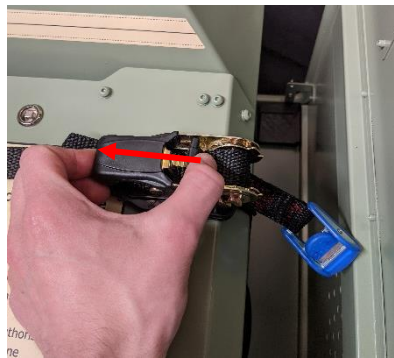
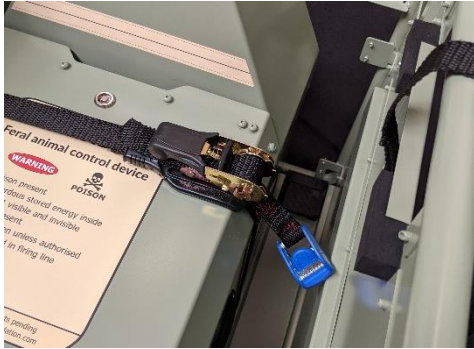

3.3 Deploying the Felixer

3.3.1 Access the accessories pouch

3.3.2 Follow the Felixer user manual on setting up the Felixer

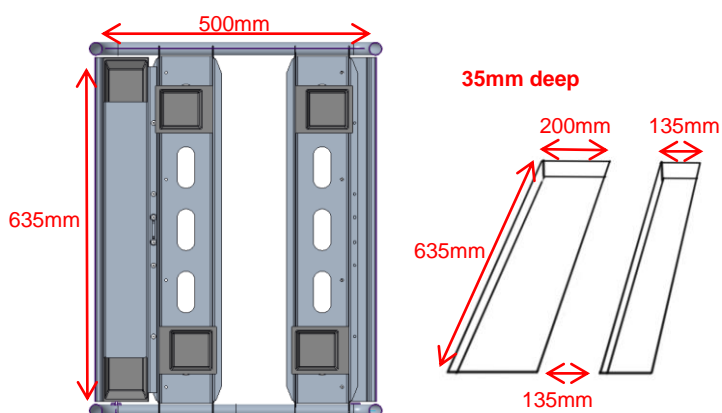

When setting up the Felixer for deployment, ensure the ground has been dug out by 35mm to ensure the Felixer retained within the crate is level with the ground.

If this step is missed, it will impact on the performance of the Felixer.

If this is not possible as the ground is too hard refer to point 3.6 Alternate deployment of the Crate.

3.4 Plugging/unplugging the charger/solar panel.

Access through the bottom panel opening.



3.5 Closing the crate for deployment

Following setting up of the Felixer, for operation:

3.5.1 Re-attaching the Felixers' retention buckle (ratchet buckle)

Refer to <https://youtu.be/uZiklOHOkNo> for how operate a ratchet straps buckle.

It should be noted that if the Felixer is active, the ratchet strap should NOT be tightened, only loosely attached so that the buckle is not loose within the crate.

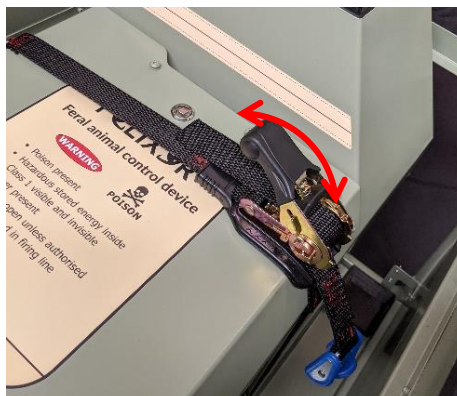
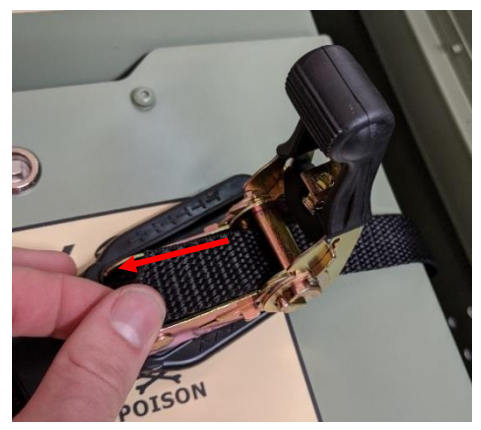
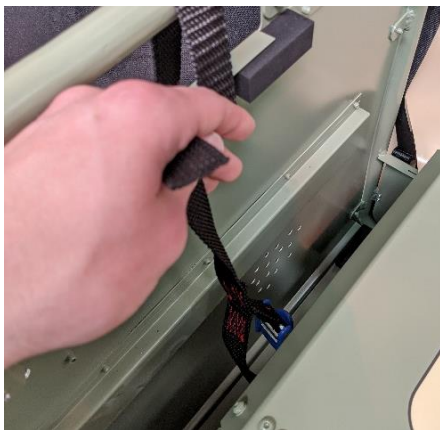

3.5.2 Attaching the canvas

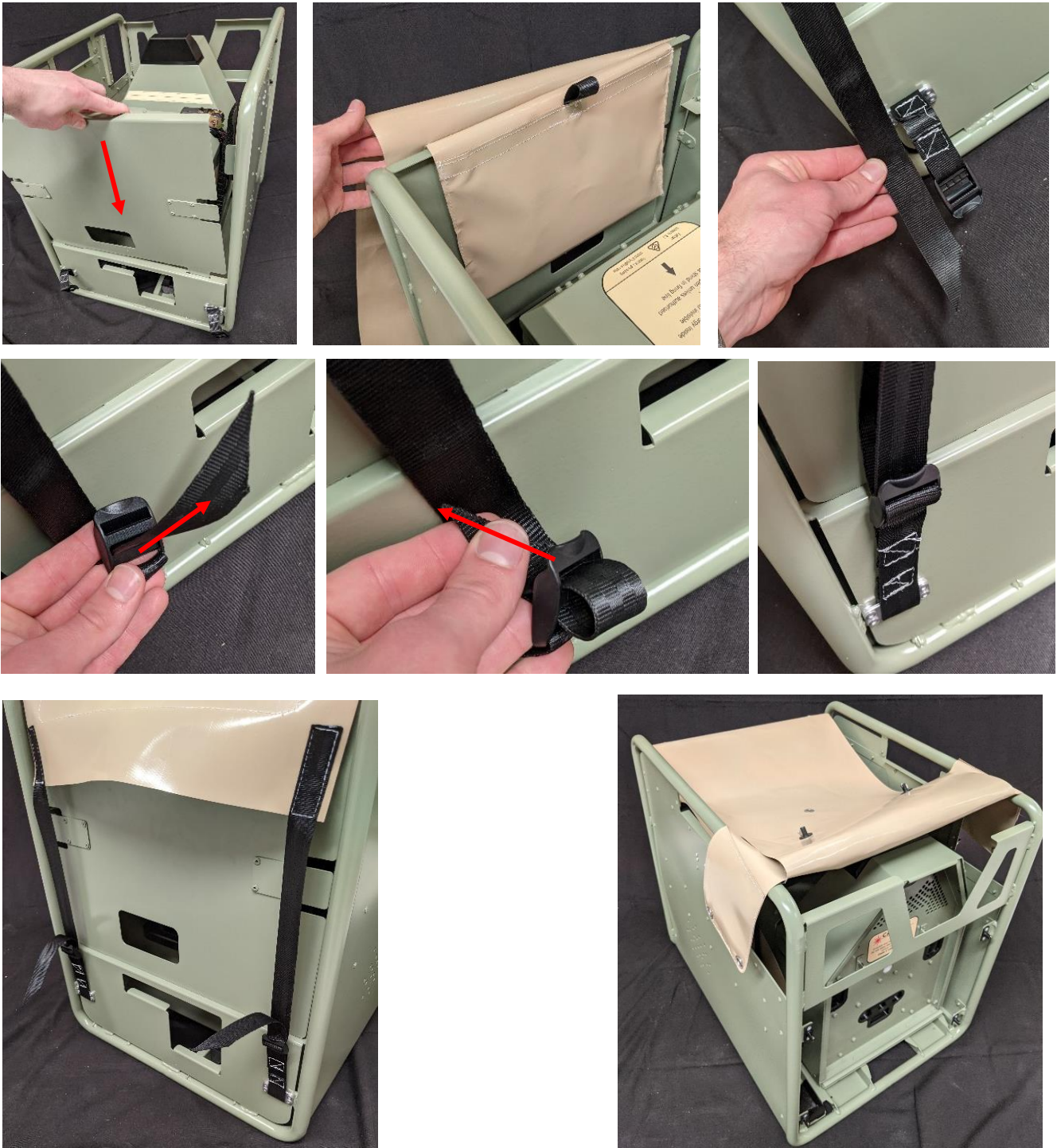

3.5.3 Locking away the canvas for deployment

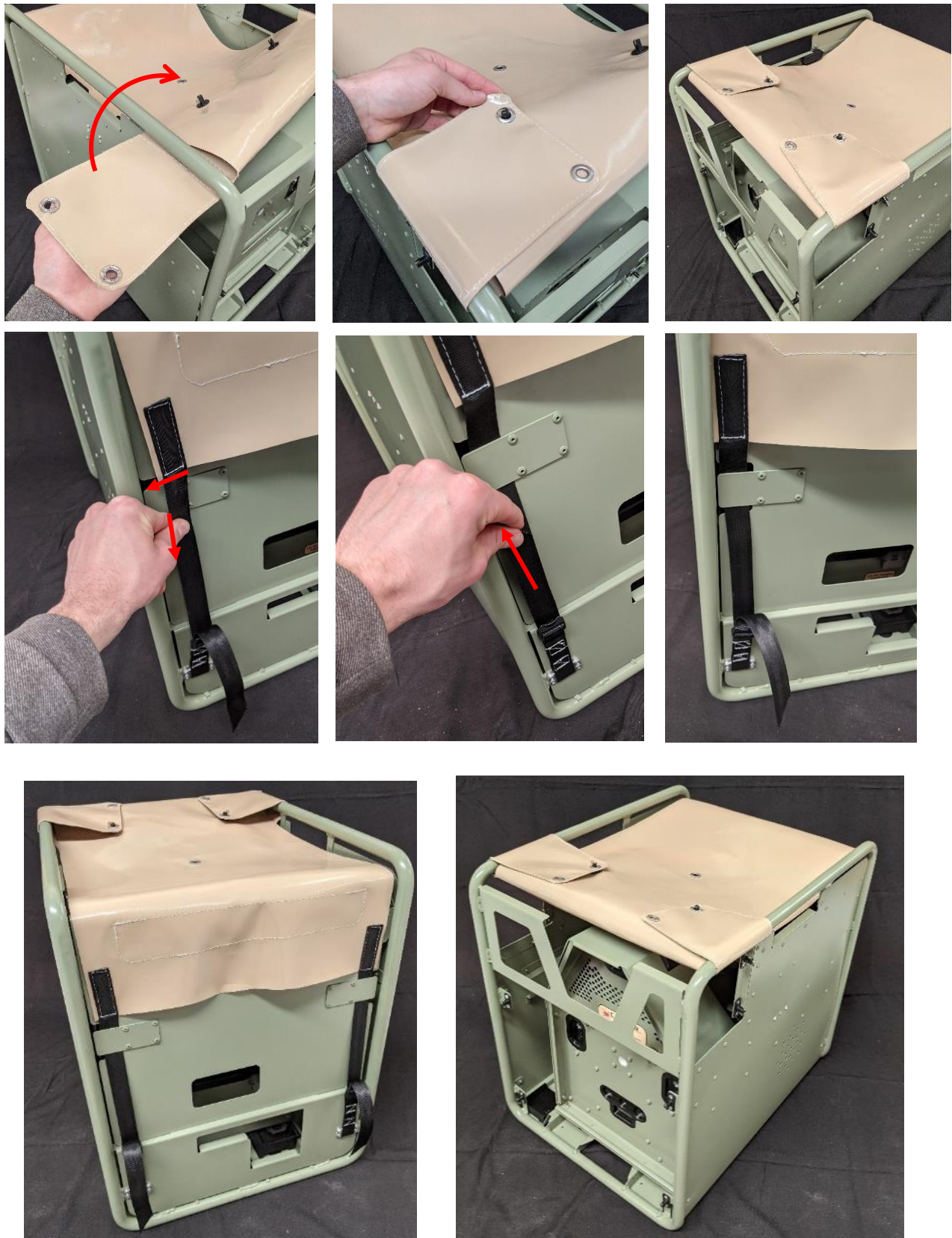

The Felixer is now ready for use.

3.6 Alternate deployment of the Crate

The Felixer is set up and deployed normally (without the crate). Once set up, the crate is turned upside down and placed on top of the Felixer, ensuring the sensors are clear as seen in the 3rd image below.



It should be noted that this is not the ideal use of crate.

This deployment should only be used in the extreme case, where the ground cannot be dug out, but the additional environmental protection is desired.

- **Note, this deployment option should be avoided if Bluetooth tags are in use due to the restricted antenna range.**

4 Deploying Felixer without crate

4.1 Removing the solar panel

4.1.1 Release the cam buckle strap

Refer <https://youtu.be/uWPqj-Yc-2c> for how to operate a cam buckle.

With the solar panel free, it can be pulled directly up and out of the crate.

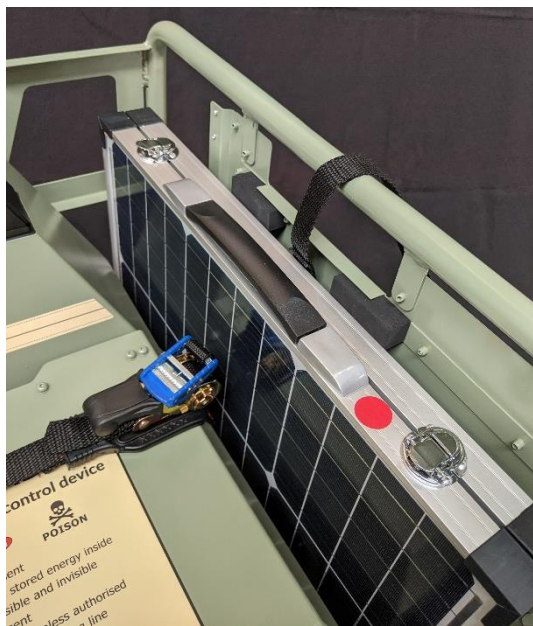

4.2 Releasing the Felixer

4.2.1 Release the Ratchet buckle

The Felixer can now be accessed by releasing the ratchet straps.

Refer to <https://youtu.be/uZIkIOHOkNo> for how operate a ratchet straps buckle.

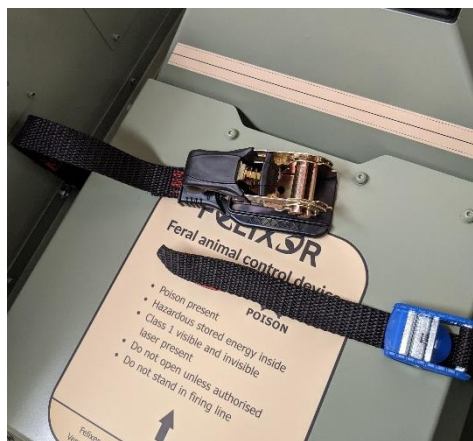
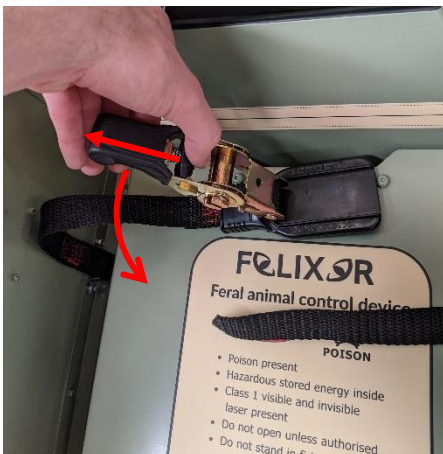
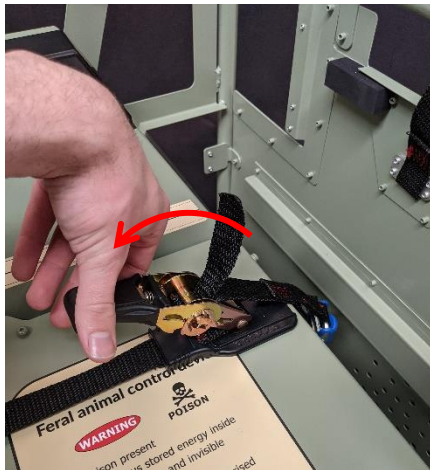
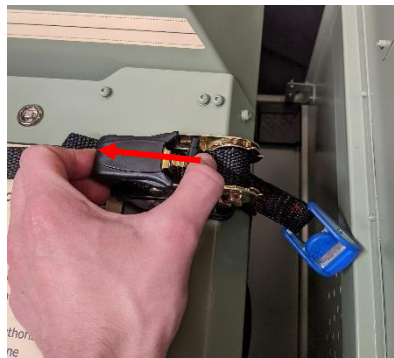
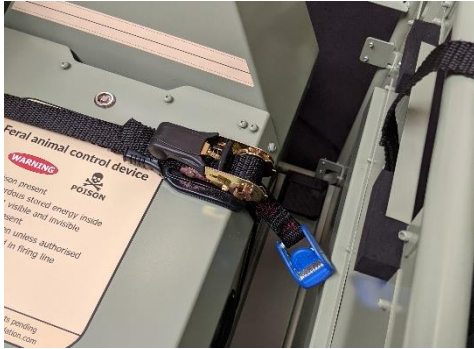

4.3 Lifting the Felixer

4.3.1 Safe lift procedure

The Felixer can now be lifted from the crate by following these steps:

1. Grasp the black handle on the rear.
2. Hold the top with your other hand.
3. Lift using your legs. The Felixer is heavy and care must be used when lifting or moving it.
4. Lift the Felixer vertically out of the crate.

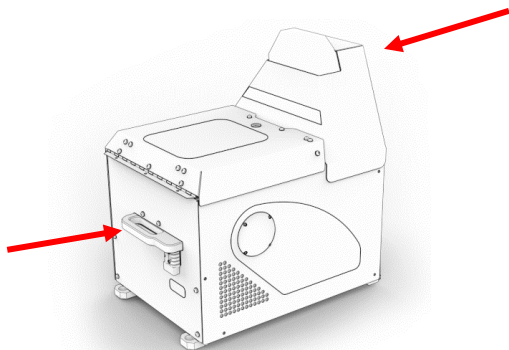

4.4 Deploying the Felixer

4.4.1 Access the accessories pouch

4.4.2 Follow the Felixer user manual on setting up the Felixer

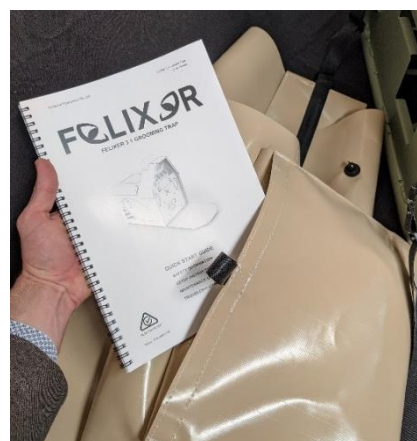

The crate should be stored safely away when not in use, such that components cannot be lost.

Crates can be stacked 3 high.

5 Packaging Felixer for freight

5.1 Placing the Felixer

Following safe lifting procedures:

1. Grasp the black handle on the rear.
2. Hold the top with your other hand.
3. Lift using your legs. The Felixer is heavy and care must be used when lifting.

Place the Felixer vertically into the crate, ensure alignment within the rubber pads



5.2 Tightening the Felixer retention strap

Refer to <https://youtu.be/uZiklOHOkNo> for how operate a ratchet straps buckle.

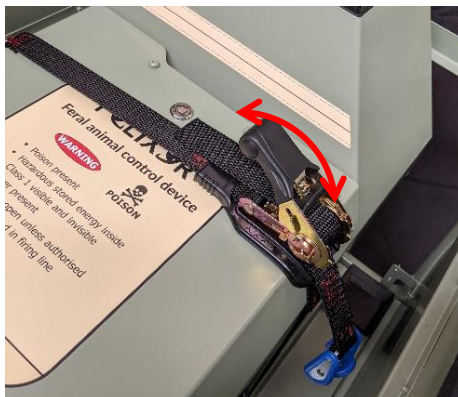
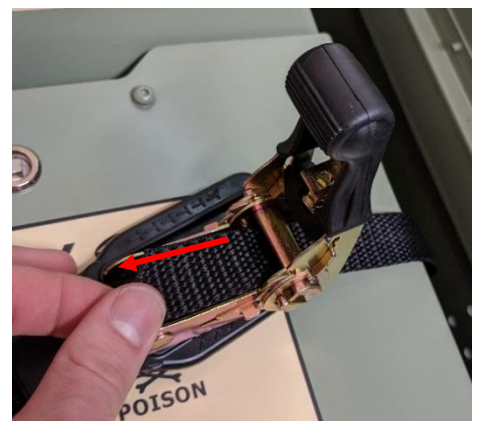
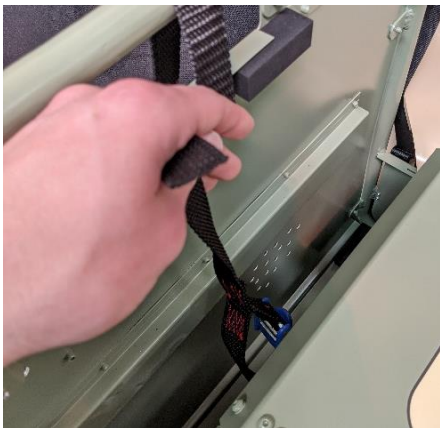

5.3 Add the solar panel

– ensure alignment in the rubber pads



5.3.1 Tighten down the solar panel

Refer to <https://youtu.be/uZiklOHOkNo> for how operate a ratchet straps buckle

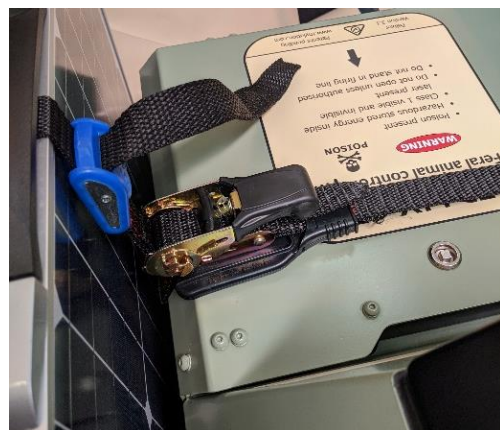
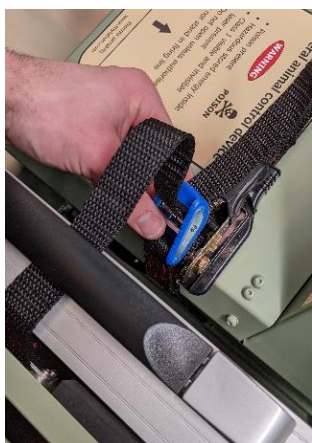

5.4 Add back panel

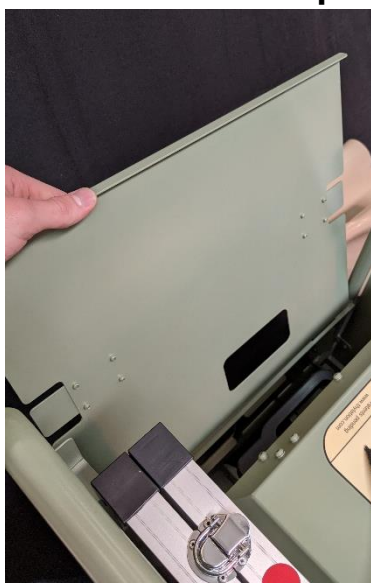

5.5 Close canvas

5.5.1 Attach onto all 8 T-toggles



5.5.2 Tighten canvas



5.6 add delivery label to rear.

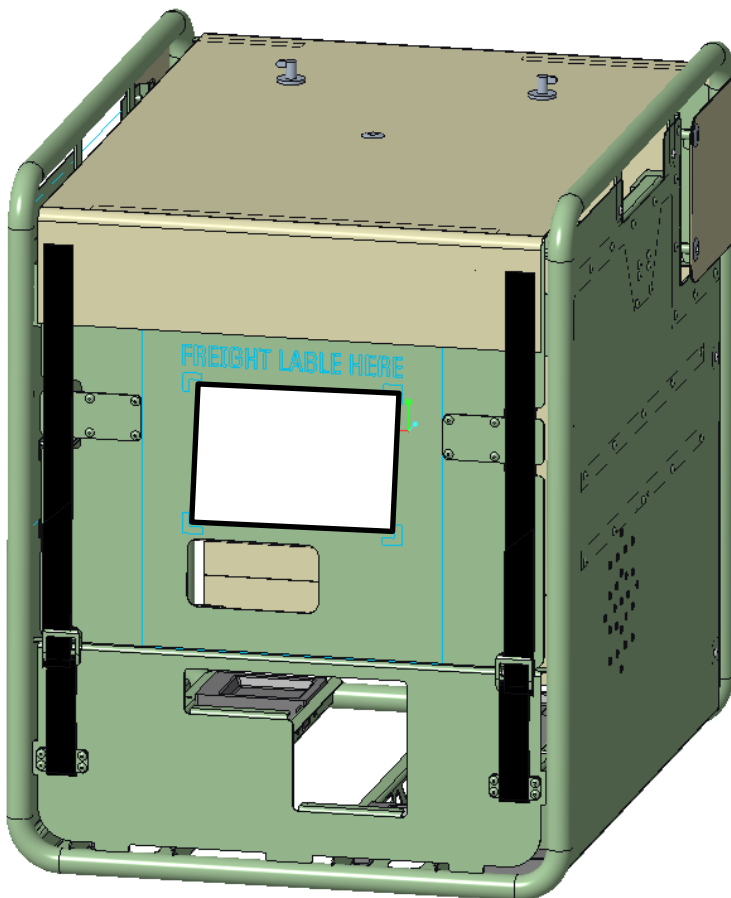

5.7 Set for delivery



